

RoHS  
COMPLIANT

Unslotted side :  
To be mated to  
SMOOTH BORE only

Slotted side :  
To be mated to  
FULL on LIMITED DETENT

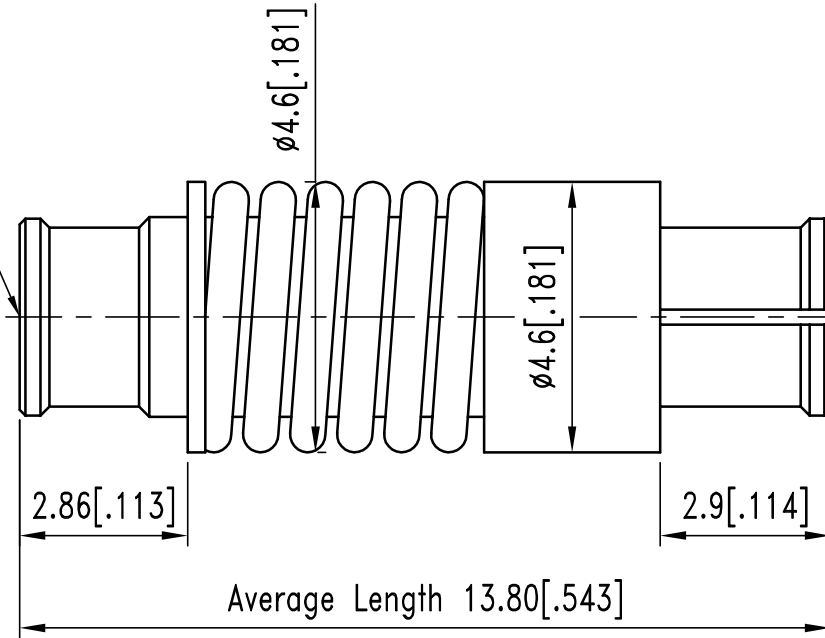

### SPECIFICATIONS :

1. IMPEDANCE : 50 OHMS
2. pre-load - No compression Overall length  
L = 14.43 mm pre-load = 9 N min
3. Maximum Compression = 1.27 mm  
Overall length L = 13.26 mm Load F = 13.6 N max.
4. GOLD FINISH : 6 microinches OVER BeCu(BODY)
5. GOLD FINISH : 30 microinches OVER BeCu(CONTACT)
6. PASSIVATED FINISH : passivated OVER SUS304 (SPRING)
7. REMOVED ALL BURRS & BREAK ALL SHARP EDGES

8	SPRING	145-A01H-B0-SP	1	SUS304	PASSIVATED
7	DIELECTRIC	145-A01H-70-DX	2	PTFE	NONE
6	CONTACT	145-A01H-50-AC	1	BeCu	GOLD
5	CONTACT	145-A01H-40-AC	1	BeCu	GOLD
4	BODY	145-A01H-25-NP	1	SUS303	PASSIVATED
3	BODY	145-A01H-20-AK	1	BeCu	GOLD
2	BODY	145-A01H-15-NP	1	SUS303	PASSIVATED
1	BODY	145-A01H-10-AK	1	BeCu	GOLD

REV	ECN NO.	NAME	DATE	TOLERANCE: DECIMALS:
				.XX $\pm 0.10$ .X $\pm 0.25$ DIAMETER: $\pm 0.10$
A1		MARS	02/21/17	

HUANG LIANG Technologies CO., LTD

TITLE. SMP BLINDMATE  
INTERCONNECT (SELF ADJUSTING)

Drawn	Checked	Approved	Unit
<i>M.A.P</i>	<i>J.C.H</i>	<i>H.T.LIN</i>	mm
02/21/17	02/21/17	02/21/17	

DWG.NO. 145-A01H/118

ITEM	DESCRIPTION	PART NUMBER	QTY	MATERIAL	FINISH	File Path: FILE.PATH	A4	SCALE	SHEET	SERIES
								8/1	1 OF 1	SMP